

Plat of Corder/Hall Subdivision

0.602 acres (26,213.58 square feet) of land out of the southwest 400 feet of Survey 632, Abstract 1557, Mustang Island, Nueces County, Texas.

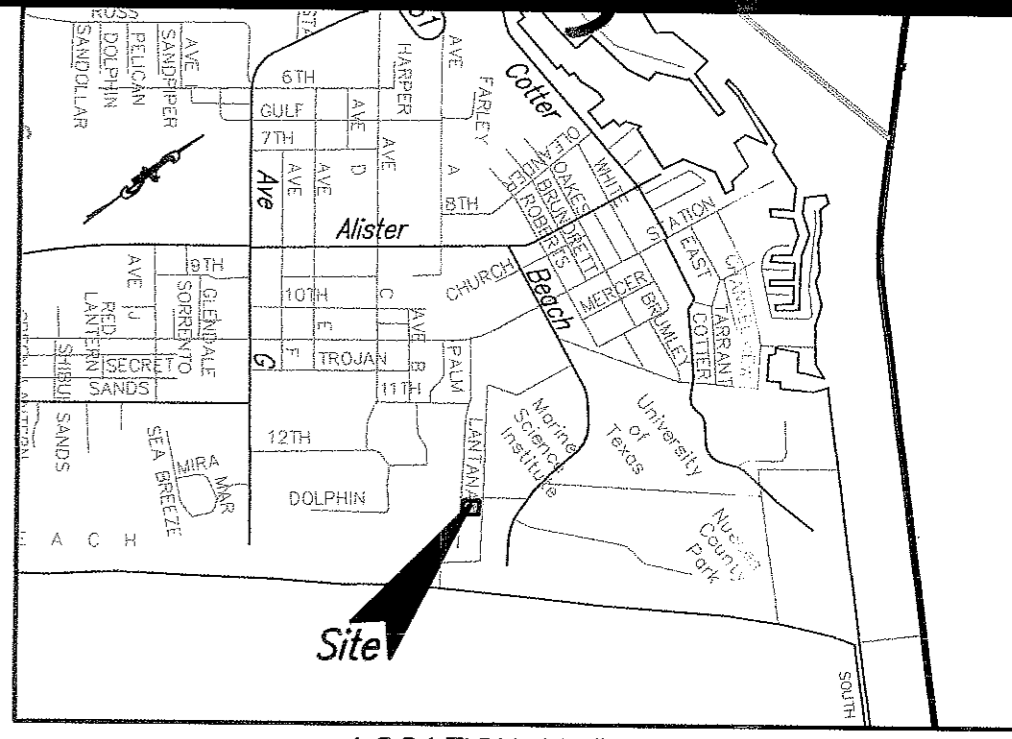

LOCATION MAP N.T.S.

Notes:

- 1.) Total platted area contains 0.602 acres (26,213.58 square feet) of land. (Includes Street Dedication)
- 2.) Set 5/8 inch iron rod with red plastic cap labeled "URBAN ENGR. C.C. TX" at all lot corners, except where noted.
- 3.) Bearings are based on Warranty Deed, recorded in Document No. 925323, dated August 11, 1994, Deed Records of Nueces County, Texas.
- 4.) By graphic plotting only, this property is in Zone "VE (EL 11)" on Flood Insurance Rate Map, Community Panel No. 485498 0004 F, City of Port Aransas, Texas, which bears an effective date of September 30, 1992 and is in a Special Flood Hazard Area.
- 5.) 5 foot side yards required unless shown otherwise on the plat.

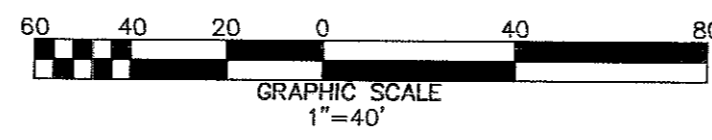

State of Texas
County of Nueces

I, Rebecca E. Corder, hereby certify that I am the owner of a 50 percent undivided interest of this 0.602 acre tract as shown on the foregoing plat and will ultimately be the owner of Lot 2, Block 3 at the time of recording; that I have had said lands surveyed and subdivided as shown; that streets shown are dedicated to the public use forever; that easements as shown are dedicated to the public use for the installation, operation and use of public utilities; and that this map was made for the purpose of description and dedication.

This the 7th day of August, 2003
Rebecca E. Corder
Rebecca E. Corder

State of Texas
County of Nueces

This instrument was acknowledged before me by Rebecca E. Corder.

This the 7 day of Aug, 2003
[Signature]

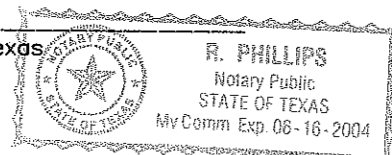

Notary Public in and for the State of Texas

State of Texas
County of Nueces

I, Larry Don Hall and Dorothy D. Lane, hereby certify that I am the owner of a 50 percent undivided interest of this 0.602 acre tract as shown on the foregoing plat and will ultimately be the owner of Lot 3, Block 1 at the time of recording; that I have had said lands surveyed and subdivided as shown; that streets shown are dedicated to the public use forever; that easements as shown are dedicated to the public use for the installation, operation and use of public utilities; and that this map was made for the purpose of description and dedication.

This the 7th day of August, 2003
Larry Don Hall
Larry Don Hall

[Signature]
Dorothy D. Lane

State of Texas
County of Nueces

This instrument was acknowledged before me by Larry Don Hall and Dorothy D. Lane.

This the 7th day of August, 2003
Amelia M. Barnes
Notary Public in and for the State of Texas

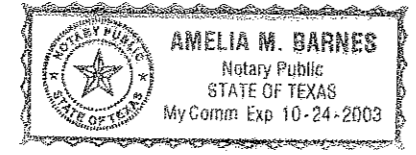

State of Texas
County of Nueces

American Bank, N.A., a National Association, hereby certifies that it holds a lien on the property owned by Rebecca E. Corder, Larry Don Hall, and Dorothy D. Lane, as shown on the foregoing map and it approves of the subdivision and dedication for the purposes and considerations therein expressed.

This the 7th day of August, 2003

American Bank, N.A.
[Signature]
By: George Horner, Port Aransas Branch President

State of Texas
County of Nueces

This instrument was acknowledged before me by George Horner, as Port Aransas Branch President of American Bank, N.A., a National Association, on behalf of said Bank.

This the 7th day of August, 2003
Amelia M. Barnes
Notary Public in and for the State of Texas

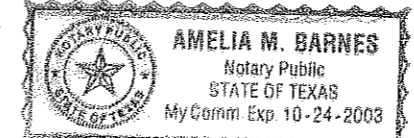

State of Texas
County of Nueces

I, Dan L. Urban, a Registered Professional Land Surveyor for Urban Engineering, have prepared the foregoing map from a survey made on the ground under my direction and is true and correct to the best of my knowledge, information and belief; I have been engaged under contract to set all Lot and Block corners as shown hereon and to complete such operations with due and reasonable diligence consistent with sound professional practice.

This the 6th day of August, 2003
[Signature]
Dan L. Urban, R.P.L.S.
Texas License No. 4710

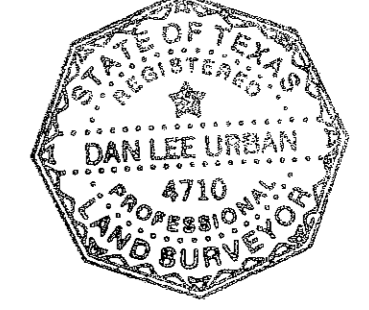

State of Texas
County of Nueces

This final plat of the herein described property was approved by the City Engineer for the City of Port Aransas, Texas.

This the 15th day of August, 2003
[Signature]
City Engineer

State of Texas
County of Nueces

This final plat of the herein described property was approved on behalf of the City of Port Aransas, Texas by the Planning Commission.

This the 15th day of August, 2003
[Signature]
Chairman of Planning and Zoning Commission

[Signature]
City Secretary

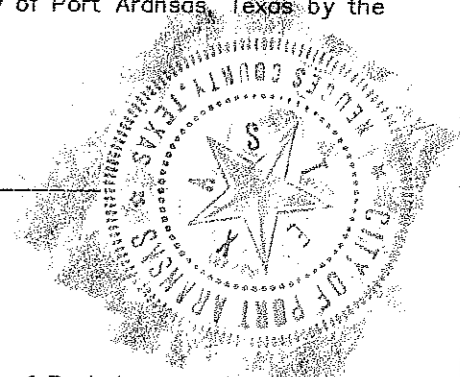

State of Texas
County of Nueces

This final plat of the herein described property was approved on behalf of the City of Port Aransas, Texas by the City Council.

This the 15th day of August, 2003
[Signature]
Mayor

[Signature]
City Secretary

State of Texas
County of Nueces

I, Ernest Briones, Clerk of the County Court in and for said County, do hereby certify that the foregoing instrument dated the 7 day of August, 2003, with its certificate of authentication was filed for record in my office the 18 day of August, 2003, at 9:28 o'clock A.M., and duly recorded the 18 day of August, 2003, at 9:28 o'clock A.M., in said County in Volume 62, Page 197, Map Record.

Witness my hand and seal of the County Court, in and for said County, at office in Corpus Christi, Texas, the day and year last written.

No. 2003042817
Filed for Record
at 9:28 o'clock A.M.
August 18, 2003

[Signature]
Ernest Briones, County Clerk
Nueces County, Texas

[Signature]
Deputy
Juanita Ramirez

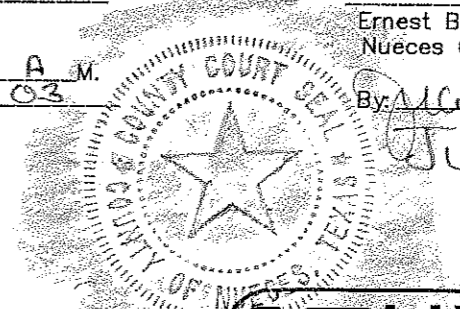

Ernest Briones
Clerk County Court
Nueces County, Texas

By: [Signature]
Deputy
Juanita Ramirez



DATE: AUG. 6, 2003
SCALE: 1" = 40'
JOB NO. 37947.00.00
SHEET 1 OF 1