

**Plat of  
Bent Tree Unit 2  
Block 6, Lots 9A and 10A**

being a replat of Lot 8A, Block 6, Bent Tree Unit 2, a map of which is recorded in Volume 62, Pages 7-8, Map Records, Nueces County, Texas.

LINE	BEARING	DISTANCE
L1	S03°53'11"W	27.54'
L2	S02°29'40"W	28.02'
L3	N29°00'00"E	60.00'
L4	N60°58'15"W	64.13'
L5	N15°58'15"W	47.32'
L6	S15°58'15"E	47.32'

- Notes:**
- Total platted area contains 7.842 acres of land.
  - The receiving water for storm water runoff is the Oso Bay Basin. The TCEQ has classified the aquatic life use for the Oso Bay as "exceptional" and "oyster waters" and also categorized the receiving water as "contact recreation" use.
  - Bearings based on the recorded plat of Lots 7A and 8A, Block 6, Bent Tree Unit 2, a map of which is recorded in Volume 62, Pages 7-8, Map Records of Nueces County, Texas.
  - By graphic plotting only, this property is in Zone "C" of the Flood Insurance Rate Map, Community Panel Number 485464 0315 D, City of Corpus Christi, Texas, which bears an effective date of August 3, 1989 and is not in a Special Flood Hazard Area.
  - If any lot is developed with residential uses, a park settlement fee will be required during the permitting phase.
  - The 60 foot wide drainage easement is to be privately maintained until an underground storm sewer is constructed within the drainage easement.
  - Public water and drainage improvements will be constructed as part of the plan of development of Lot 9A, Block 6 and require city approval prior to issuance of a Certificate of Occupancy.

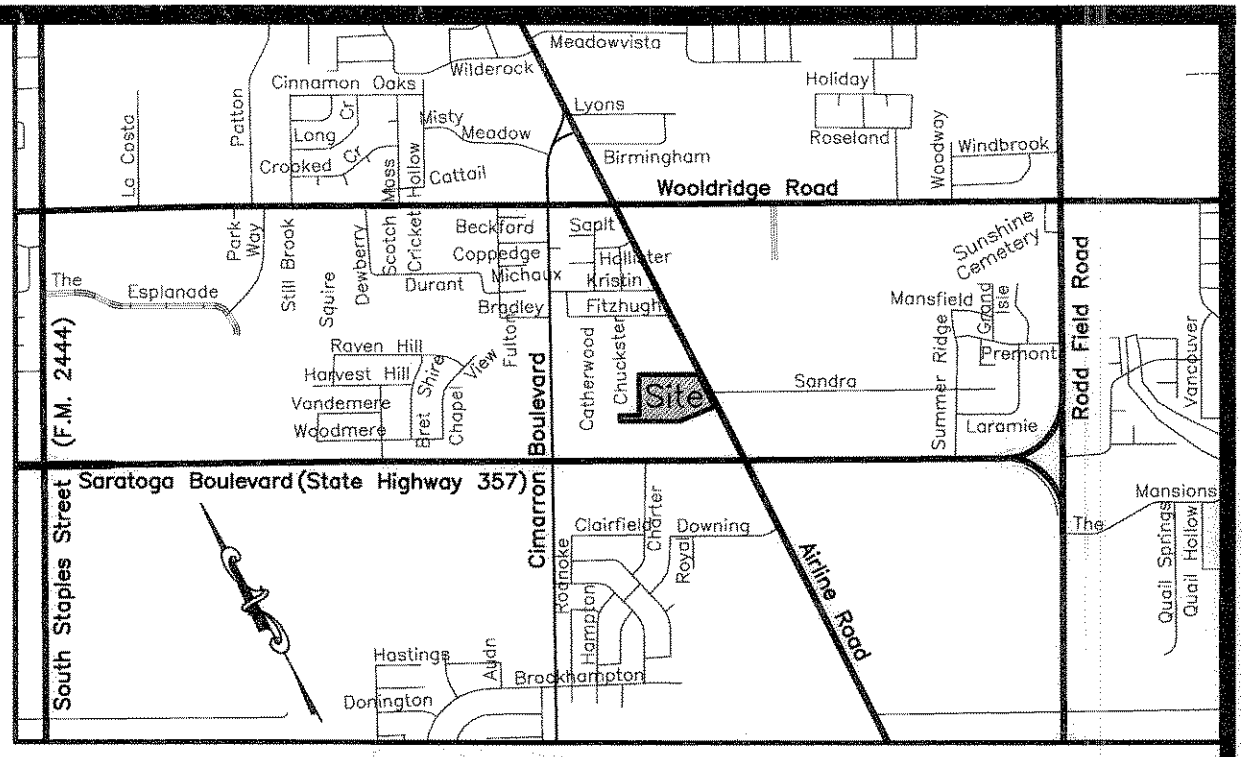

LOCATION MAP N.T.S.

State of Texas  
County of Nueces

I, Dan L. Urban, a Registered Professional Land Surveyor for Urban Engineering, have prepared the foregoing map from a survey made on the ground under my direction and is true and correct to the best of my knowledge, information and belief; I have been engaged under contract to set all Lot and Block corners as shown hereon and to complete such operations with due and reasonable diligence consistent with sound professional practice.

This the 15<sup>th</sup> day of JUNE, 2005  
*Dan L. Urban*  
 Dan L. Urban, R.P.L.S.  
 Texas License No. 4710

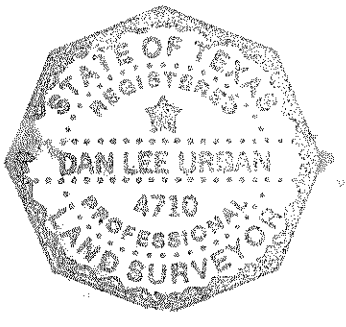

State of Texas  
County of Nueces

This final plat of the herein described property was approved by the Department of Engineering Services of the City of Corpus Christi, Texas.

This the 5<sup>th</sup> day of July, 2005  
*Angel R. Escobar*  
 Angel R. Escobar, P.E./R.P.L.S.  
 Director of Engineering Services

State of Texas  
County of Nueces

This final plat of the herein described property was approved on behalf of the City of Corpus Christi, Texas by the Planning Commission.

This the 4<sup>th</sup> day of MAY, 2005  
*Michael N. Gunning*  
 Michael N. Gunning  
 Secretary  
 0505066-NP35

*David Berlanga Sr.*  
 David Berlanga, Sr., Chairman

State of Texas  
County of Nueces

I, Diana T. Barrera, Clerk of the County Court in and for said County, do hereby certify that the foregoing instrument dated the 16<sup>th</sup> day of June, 2005, with its certificate of authentication was filed for record in my office the 16<sup>th</sup> day of July, 2005. At 4:38 O'clock P.M., and duly recorded the 16<sup>th</sup> day of July, 2005, at 4:38 O'clock P.M., in said County in Volume 164, Page 193, Map Records.

Witness my hand and seal of the County Court, in and for said County, at office in Corpus Christi, Texas, the day and year last written.

No. 2005034240  
 Filed for Record  
 at 4:38 O'clock P.M.  
July 6, 2005

*Diana T. Barrera*  
 Diana T. Barrera, County Clerk  
 Nueces County, Texas  
 By: *Pamela B. Arriaga*  
 Deputy

Diana T. Barrera  
 Clerk County Court  
 Nueces County, Texas

By: *Pamela B. Arriaga*  
 Deputy

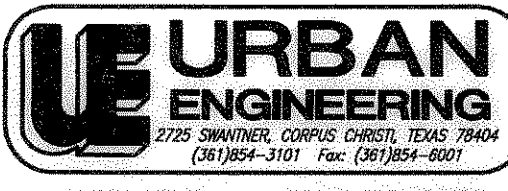

DATE: June 16, 2005  
 SCALE: 1"=100'  
 JOB NO.: 40012.00.00  
 SHEET: 1 of 1  
 DRAWN BY: XG

State of Texas  
County of Nueces

GOTCHER CONSTRUCTION INC., hereby certifies that it is the owner Lot 9A, Block 6 of the foregoing plat; that it has had said lands surveyed and subdivided as shown; that streets shown are dedicated to the public use forever; that easements as shown are dedicated to the public use for the installation, operation and use of public utilities; and that this map was made for the purpose of description and dedication.

This the 16<sup>th</sup> day of June, 2005  
 By: *Danny Gotcher*  
 DANNY GOTCHER, Owner

State of Texas  
County of Nueces

This instrument was acknowledged before me by DANNY GOTCHER, as Owner of GOTCHER CONSTRUCTION INC., on behalf of said corporation.

This the 16<sup>th</sup> day of June, 2005  
*Xavier Galvan*  
 Xavier Galvan  
 Notary Public in and for the State of Texas

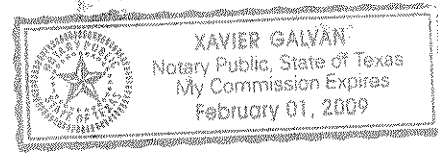

GOLDEN CRESCENT DEVELOPMENT, L.L.C., hereby certifies that it is the owner of Lot 10A, Block 6 of the foregoing plat; that it has had said lands surveyed and subdivided as shown; that streets shown are dedicated to the public use forever; that easements as shown are dedicated to the public use for the installation, operation and use of public utilities; and that this map was made for the purpose of description and dedication.

This the 25 day of June, 2005  
 By: *Nader Karimi*  
 NADER KARIMI, Partner

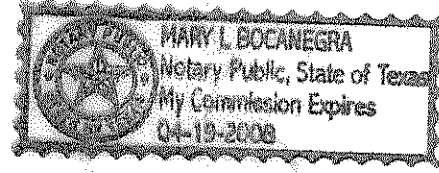

State of Texas  
County of Nueces

This instrument was acknowledged before me by NADER KARIMI, as Partner of GOLDEN CRESCENT DEVELOPMENT, L.L.C., on behalf of said corporation.

This the 25 day of June, 2005  
*Mary L. Bocanegra*  
 Notary Public in and for the State of Texas

State of Texas  
County of Nueces

GOLDEN CRESCENT DEVELOPMENT, L.L.C., hereby certifies that it is the owner of Lot 10A, Block 6 of the foregoing plat; that it has had said lands surveyed and subdivided as shown; that streets shown are dedicated to the public use forever; that easements as shown are dedicated to the public use for the installation, operation and use of public utilities; and that this map was made for the purpose of description and dedication.

This the 23 day of June, 2005  
 By: *Jalil M. Baradaran*  
 JALIL M. BARADARAN, Partner

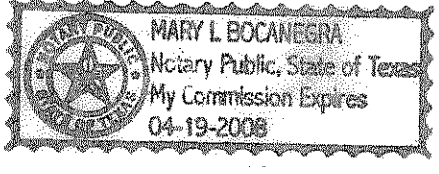

State of Texas  
County of Nueces

This instrument was acknowledged before me by JALIL M. BARADARAN, as Partner of GOLDEN CRESCENT DEVELOPMENT, L.L.C., on behalf of said corporation.

This the 23 day of June, 2005  
*Mary L. Bocanegra*  
 Notary Public in and for the State of Texas

State of Texas  
County of Nueces

GOLDEN CRESCENT DEVELOPMENT, L.L.C., hereby certifies that it is the owner of Lot 10A, Block 6 of the foregoing plat; that it has had said lands surveyed and subdivided as shown; that streets shown are dedicated to the public use forever; that easements as shown are dedicated to the public use for the installation, operation and use of public utilities; and that this map was made for the purpose of description and dedication.

This the 24<sup>th</sup> day of June, 2005  
 By: *Vahid Mostaghasi*  
 VAHID MOSTAGHASI, Partner



State of Texas  
County of Nueces

This instrument was acknowledged before me by VAHID MOSTAGHASI, as Partner of GOLDEN CRESCENT DEVELOPMENT, L.L.C., on behalf of said corporation.

This the 24<sup>th</sup> day of June, 2005  
*Mary L. Bocanegra*  
 Notary Public in and for the State of Texas

Vol: 64 Pg: 193

Vol: 64 Pg: 193